

## FEMTOmini™ Diodes in the SOD-923 package

FEMTOmini™

SOD-923

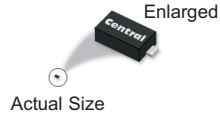

**CMAD4448**  
(Switching Diode)

**CMAD6001**  
(Low Leakage Diode)

**CMASH-4**  
(Schottky Diode)

**CMAD6263**  
(Schottky Diode)



### features

- Space Saving SOD-923 package (1.10 x 0.65mm Max)
- Low Profile (0.41mm Max)
- Ideal for battery powered and hand held applications
- Fast Switching, Low Leakage, and Schottky diodes available

### description

Designed for today's electronic products with limited board space and package height restrictions, these new SOD-923 devices meet the strictest requirements while maintaining high operational efficiency for portable handheld applications.

#### CMAD4448 (Switching Diode)

The CMAD4448 is a 120V, 250mA ultra high speed switching diode with a  $t_{rr}$  of 2.0ns (Typical) and 4.0ns (Maximum). Ideal for high speed switching applications.

#### CMAD6001 (Low Leakage Diode)

The CMAD6001 is a 100V, 250mA low leakage diode with an  $I_R$  of 500pA (Maximum). This device also has a low capacitance of 2.0pF and a  $V_F$  of 0.85V at 1.0mA.

#### CMASH-4 (Schottky Diode)

The CMASH-4 is an energy efficient 40V, 200mA Schottky diode, boasting a low forward voltage drop of 0.35V (Typical) and 0.38V (Maximum) at 1.0mA.

#### CMAD6263 (Schottky Diode)

The CMAD6263 is an energy efficient 70V, 15mA Schottky diode, boasting a low forward voltage drop of 0.395V (Typical) and 0.410V (Maximum) at 1.0mA.

### selection guide



#### Diodes in the SOD-923 package

Central Part No.	Description	$V_{RRM}$ (V) MAX	$I_F$ * $I_O$ (mA) MAX	$I_R$ (nA) MAX	@ $V_R$ (V)	$V_F$		$t_{rr}$ MAX	$C_T$ (pF) MAX
						(V) MAX	@ $I_F$ (mA)		
CMAD4448	Switching Diode	120	250	300	50	0.65 0.77 1.00	1.0 10 100	2.0ns (TYP) 4.0ns	2.0
CMAD6001	Ultra Low Leakage Diode	100	250	0.5	75	0.85 0.95 1.10	1.0 10 100	3.0µs	2.0
CMASH-4	Schottky Diode	40	*200	200	30	0.38 0.65 1.00	1.0 15 40	5.0ns	5.0
**CMAD6263	Schottky Diode	70	15	200	50	0.395 (TYP) 0.410	1.0	5.0ns	2.0

\*\* In development

Sample Devices  
available  
upon request.

# FEMTOmini™ Diodes in the SOD-923 package

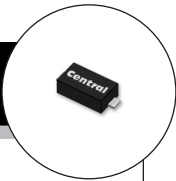

## Mechanical Specifications - SOD-923

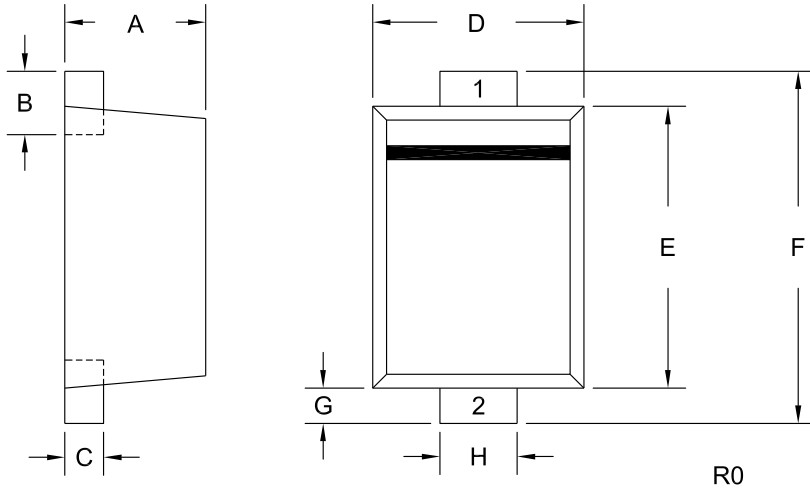

SYMBOL	INCHES		MILLIMETERS	
	MIN	MAX	MIN	MAX
A	0.015	0.016	0.39	0.41
B	0.004	0.010	0.10	0.26
C	0.003	0.006	0.08	0.14
D	0.022	0.026	0.55	0.65
E	0.030	0.033	0.75	0.85
F	0.035	0.043	0.90	1.10
G	0.002	0.006	0.05	0.15
H	0.007	0.011	0.17	0.27

SOD-923 (REV: R0)

### MARKING CODE:

- CMAD6001: Q
- CMAD4448: M
- CMASH-4: A
- CMAD6263: J

### Tape Dimensions and Orientation (Dimensions in mm)

Tape Width: 8mm

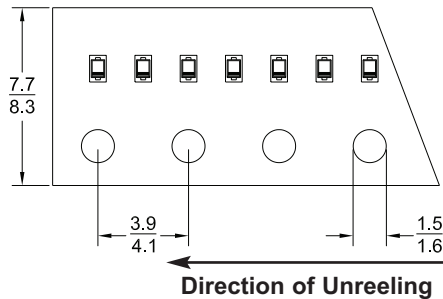

\* Devices are taped in accordance with Electronic Industries Association Standard EIA-481-1-A

### Mounting Pad Geometry (Dimensions in mm)

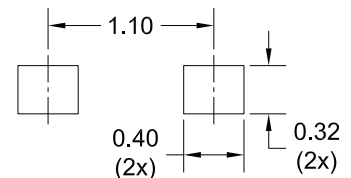

R0

**Central**<sup>™</sup>  
Semiconductor Corp.

*Innovations in Discrete Semiconductors*

For further information contact:  
Sales at Central Semiconductor Corp.  
(631) 435-1110 or visit our website at:  
[www.centalsemi.com](http://www.centalsemi.com)

145 Adams Avenue • Hauppauge • New York • 11788 • USA • Tel:(631) 435-1110 • Fax:(631) 435-1824

PA SOD-923 Diodes